

Artemide[®]
ARCHITECTURAL

Mara Spentza

Architect – Lighting Designer

**Ba(Hons)Arch, Dip. Arch,
MArch, MSc. Light & Lighting**

LIGHTING MASTERPLANS

ARCHITECTURAL LIGHTING OF BUILDINGS



Paris



Edinburgh



London



Lyon

LIGHTING MASTERPLANS - Introduction

Holistic approach in the context of a whole urban composition.

Conflicting aims of urban activities.

Planning control on exterior lighting is necessary to protect the environment.

City night time improvement - Urban Lighting boosts the economy!

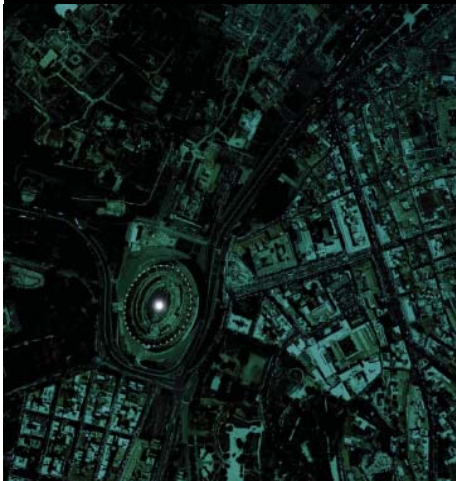

Mirabella Urbis, 2001.

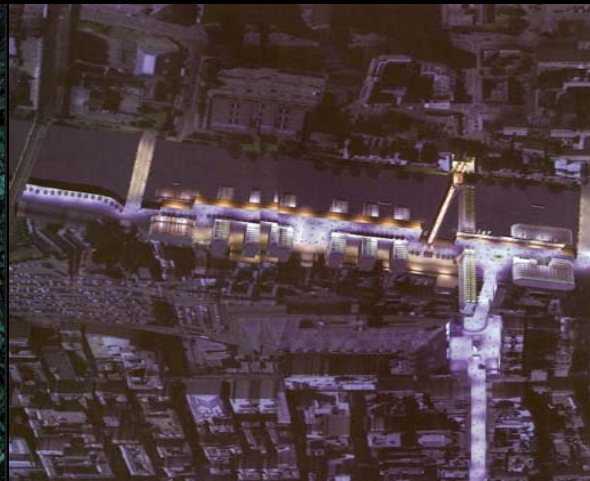

Masterplan at Custom Quay in Glasgow by RMJM Architects aimed at creating a stimulating 24 hour activity and regenerate the Clydeside riverfront.



Stuttgart City Centre. Illuminated Landmarks : The Tablat Tower The Ring Road in Red Lighting.



Lighting Masterplan for Stuttgart. Lighting Design: Licht

URBAN LIGHTING PLANS

Awareness of the benefits of lighting our Towns, Cities and Communities is growing.

Light as an element for a strong culture.

Birth of a new formal language derives from new technologies and new applications.

Lighting Design Profession as a global requirement.



Technical Lighting

Luminaire Design as a feature of urban spaces

Scenic Lighting

Coloured Light

Dynamic Light

... 1950 ... 1955 ... 1960 ... 1965 ... 1970 ... 1975 ... 1980 ... 1985 ... 1990 ... 1995 ... 2000 ... 2005

URBAN LIGHTING PLANS

Existing Planning Legislation.

Lighting Guides – Codes of Practice.

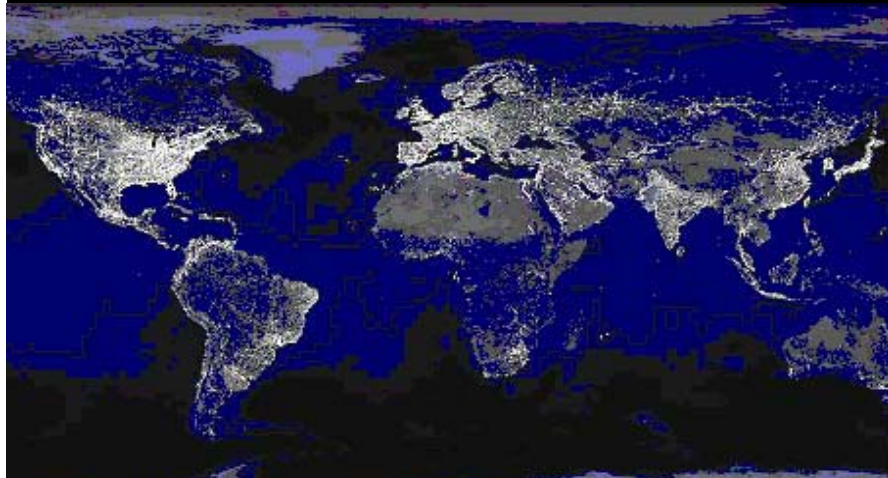

The World at Night!



Guangzhou, China, 2007.

URBAN LIGHTING PLANS

Why we should Light!

Ambience



Palais Du Luxemburg, Paris.



Lyon at Night.

URBAN LIGHTING PLANS

Why we should Light!

Identity



*Ladenburg, Germany
Artemide, Rivoli.*



*Byzantine Water Supply Reservoir,
Istanbul.*

URBAN LIGHTING PLANS

Why we should Light!

Safety



Guangzhou, China.

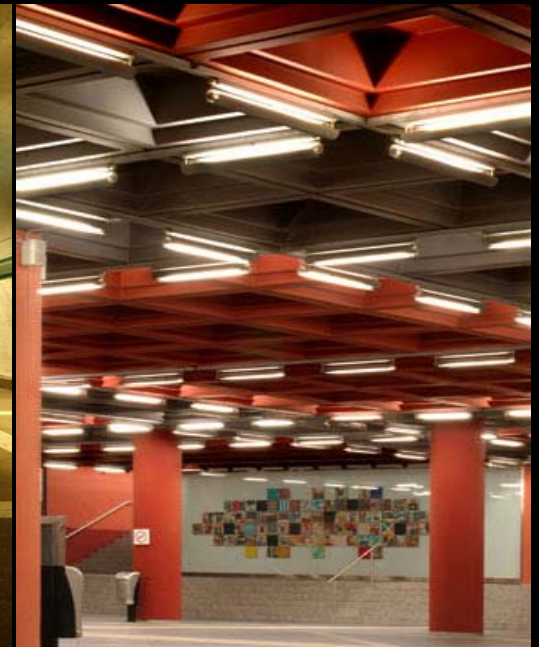

Parking Site, Athens.

URBAN LIGHTING PLANS

Why we should Light!

Security



Road and Amenity Lighting: London, Athens, Spoleto – Italy.

URBAN LIGHTING PLANS

Why we should Light!

Orientation



Perspective is enhanced.



An overall Lighting Approach for the City of Guangzhou, China.

URBAN LIGHTING PLANS

Why we should Light!

Promotion



Eurobank Investment, Athens



Editrice Abitare Segesta, Milan, Italy.



City of Guangzhou, China.

URBAN LIGHTING PLANS

Why we should Light!

*Volharding, Hague, 1929, Jan Buys.
Eiffel Tower 1889, Paris.*



Spectacle



Palais Du Luxemburg, Paris.

URBAN LIGHTING PLANS

Why Not Light!

Is Lighting Necessary or Desirable?

Acceptable lighting solutions in the Urban Context – Inappropriate in Rural Context.

Lighting used as a method to attract potential clients – Results in escalation in lighting levels.

Flat, uniform lighting swamps important Architectural and Historical installations.



URBAN LIGHTING PLANS

Lighting Design Considerations

A mental Map – How do people understand the layout of a place?

Paths: Streets, trails, circulation.

Edges: Perceived boundaries: walls, buildings, shorelines.

Districts: Sections of the City with some identity or character.

Nodes: Focal points, intersections.

Landmarks: Readily identifiable objects serve as reference points.

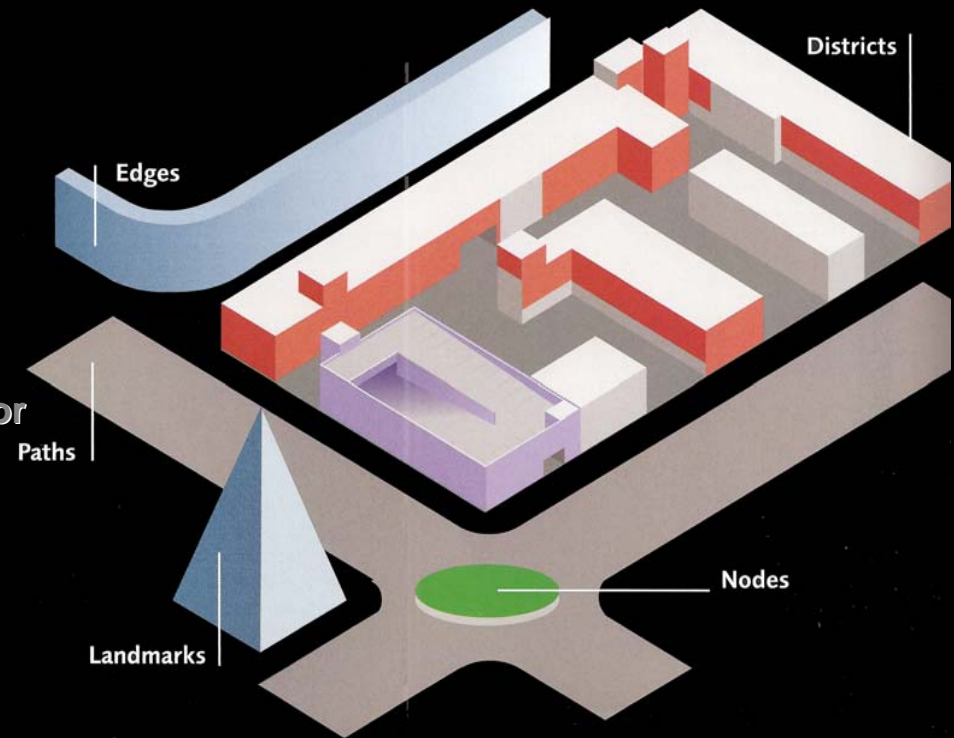

*"The Image of the City",
Elements of a Masterplan, according to Kevin Lynch.*

URBAN LIGHTING PLANS

Lighting Design Considerations

1. Functional
2. Architectural
3. Amenity
4. Promotional

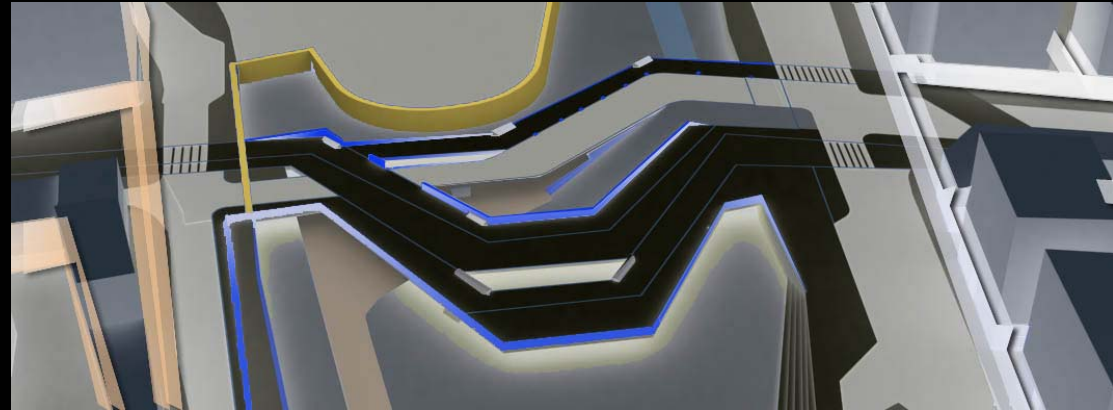

For Functional and Amenity Lighting there certain European and Local Authority Standards .(CIBSE LG6)

However for Architectural or Promotional lighting things are more subjective and will depend upon the relative brightness of the surroundings and the character of the area.



*Eleftheria Square, Cyprus, Competition Entry
Architects: Myrto Klourti, Kostas Tsiambaos
Lighting Scheme: Mara Spentza*

URBAN LIGHTING PLANS

Lighting Design Considerations

Classify the area.

Suggested headings.

Example Area	Functional	Architectural	Amenity	Promotional
Civic	xx	xxxx	xxx	x
Commercial	xx	x	xxx	xxxx
Conservation	x	xxx	xx	
Entertainment	x	xx	xxx	xxxx
Historic Core	x	xxx	xx	
Parks and Gardens	x	xxx	xxxx	xx
Residential	x		xx	
Retail	xx	x	xxxx	xxx

Edinburgh Castle at night.



Zaha Hadid Architects- Urban Planning.

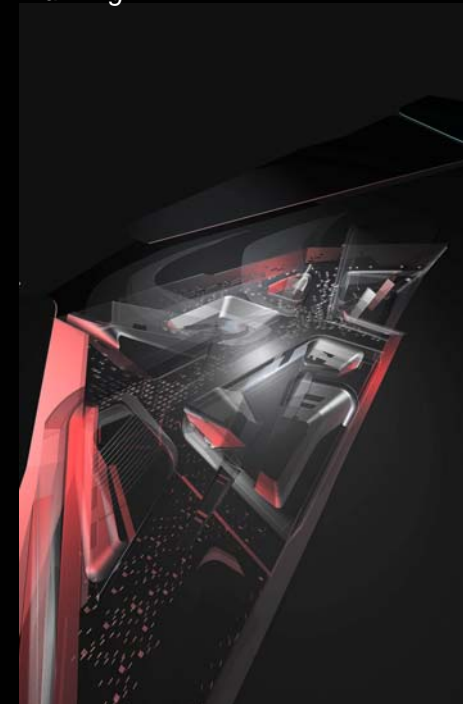

URBAN LIGHTING PLANS

Lighting Design Considerations

Identify Aims and Objectives of the Lighting Masterplan.

Choice of the principal Lighting Sources.

Which Parts of the City should Dominate - Lighting Levels
In relation to district brightness.

Hierarchy-Ranking between lighting levels of other City Elements.

Traffic Lighting for the Greater City in balance with the whole scene.

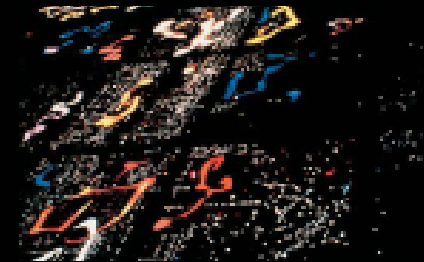

URBAN LIGHTING PLANS

The Status quo of Lighting Masterplans.

Masterplans arise from Urban Planning Departments in collaboration with Professional Lighting Designers.

Extremely dynamic Lighting market in Europe.

Economical growth and development in Asia includes lighting concepts in their expanding cities.

New energy saving codes require all Local Governments to modernize their Urban Lighting systems.



URBAN LIGHTING PLANS

Paradigms

Lyon



Stuttgart



URBAN LIGHTING PLANS

Paradigms

Edinburgh



Liverpool



URBAN LIGHTING PLANS

' We want more buildings lit because people will feel safer and so there are social benefits, but balanced against those are energy and maintenance costs' .

'The first thing is to try to be selective in what we light, rather than just blasting light on Everything'.

'Some sort of Legislation surrounding the use of energy sources is necessary'.

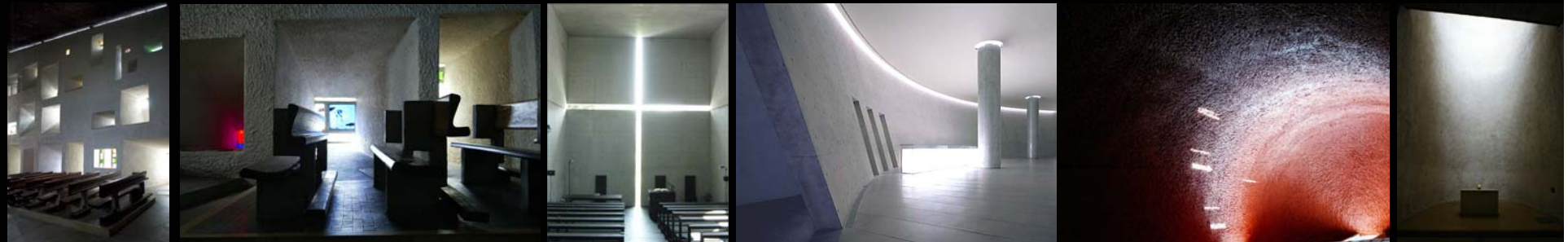

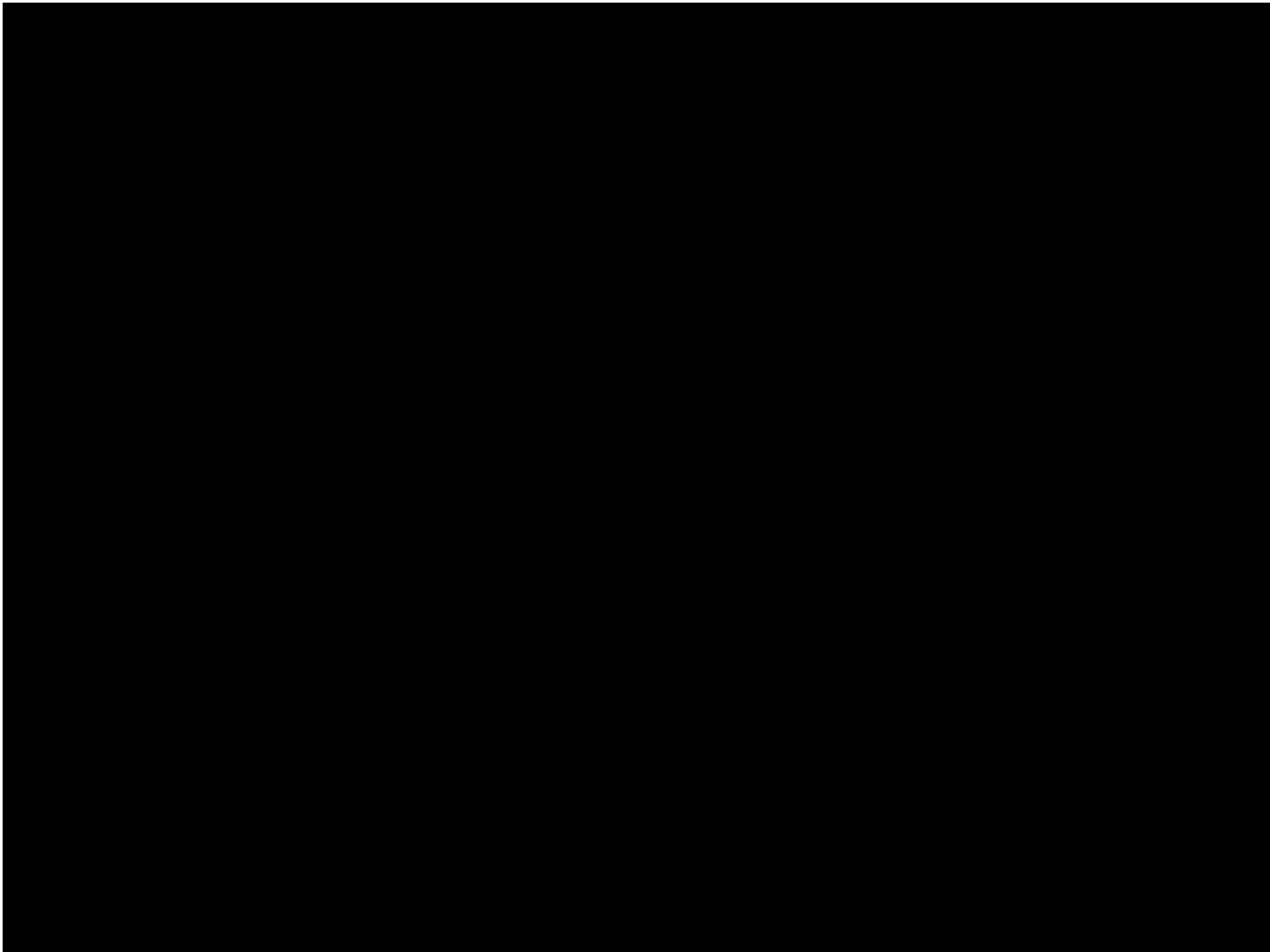

ARCHITECTURAL LIGHTING OF BUILDINGS.

Lighting Buildings of Historical Importance

Landmarks become more likely to be chosen as significant if :

- They have a clear form.
- They contrast with the background.
- There is some eminence of spatial location.



Lyon Cathedral



Patra Cathedral.
Lighting Design Mara Spentza
Awarded 'Young Lighters of the Year 2006'
CIBSE, Society Light and Lighting,
ILE Institute of Lighting Engineers, U.K.



ARCHITECTURAL LIGHTING OF BUILDINGS.

Lighting Buildings of Historical Importance

Design Considerations

Style



*Via Garibaldi
Lighting Design : Artemide Italia
Genova, Italy.*

ARCHITECTURAL LIGHTING OF BUILDINGS.

Lighting Buildings of Historical Importance

Form - Contrast



*Aristotelous Street Façade
Lighting Design : Artemide Thessaloniki
Greece.*



ARCHITECTURAL LIGHTING OF BUILDINGS.

Lighting Buildings of Historical Importance

Shadows



Via Garibaldi, Genova, Italy, ARTEMIDE Architectural

ARCHITECTURAL LIGHTING OF BUILDINGS.

Lighting Buildings of Historical Importance



Colour

*Maizonos Street Façade, Patra, Greece
Lighting Design : Artemide, Greece.*



ARCHITECTURAL LIGHTING OF BUILDINGS.

Lighting Buildings of Historical Importance

Should the building be lit?

Does the entire building need to be lit.

Which are the significant architectural elements of the building. : Pediments, Columns, Porticos.



Venice, Italy.

ARCHITECTURAL LIGHTING OF BUILDINGS.

Lighting Buildings of Historical Importance

Two more factors need to be considered:

- The required appearance of the building
In terms of its background and surroundings.

- The need to bring out colour, texture and detailing.



Via Garibaldi, Genova, Italy, ARTEMIDE Architectural

LIGHTING MASTERPLANS - ARCHITECTURAL LIGHTING OF BUILDINGS.

*'Architecture is the learned game, correct and magnificent,
of forms assembled in light'.*

Le Corbusier.



Mara Spentza
Architect – Lighting Designer
Ba(Hons)Arch, Dip. Arch,
MArch, MSc. Light & Lighting

Artemide[®]
ARCHITECTURAL